



NOTES

Site Boundary

1:500 Scale Bar (m.)

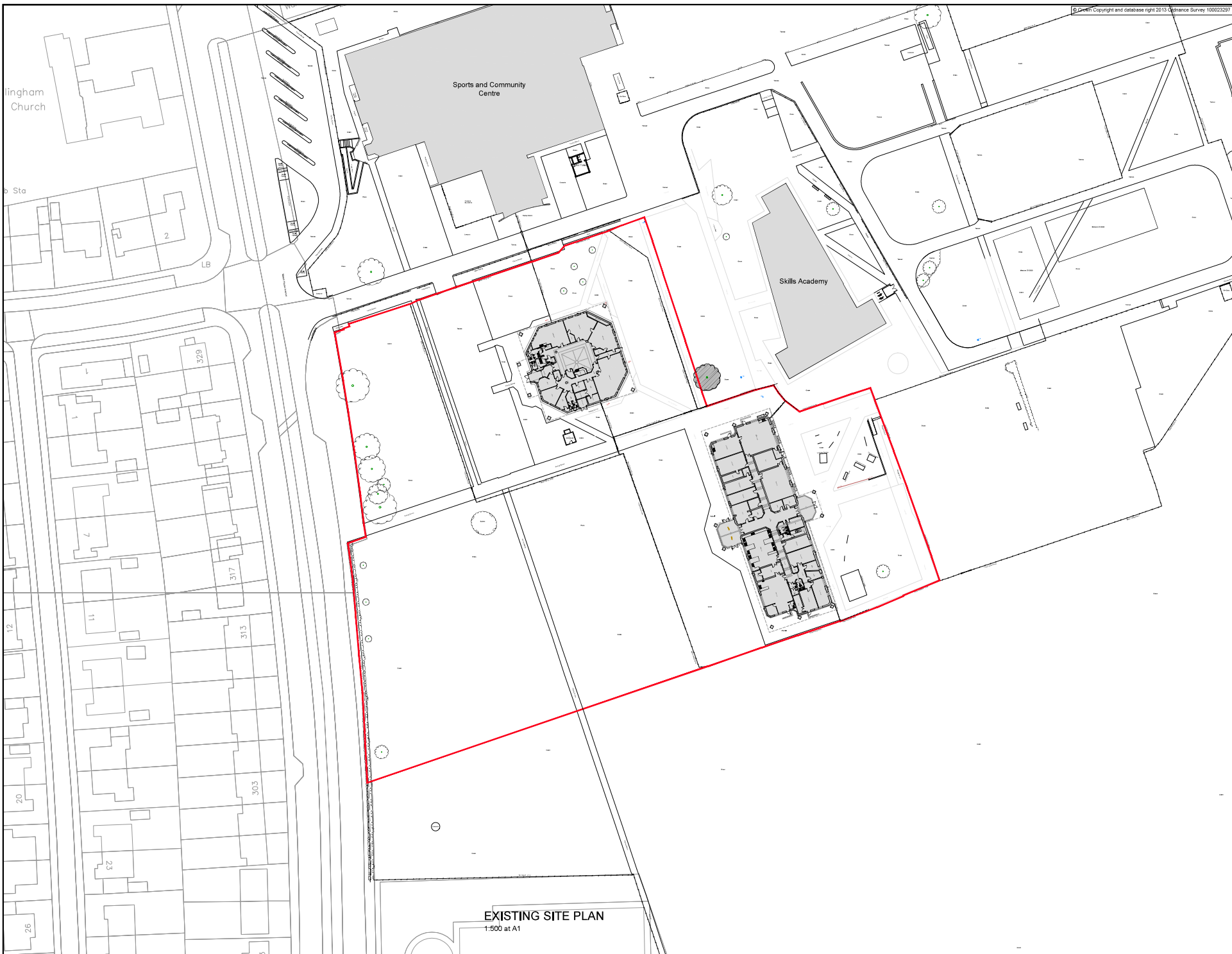

P03 PLANNING SUBMISSION	03/11/21
P02 PRE-APP SUBMISSION	05/10/21
P01 FIRST PRELIMINARY ISSUE	07/07/21

Rev	Description	Chk	Chk	Date
0				

Drawing Status: PRELIMINARY APPROVAL

INFORMATION TENDER CONSTRUCTION



Stockton-on-Tees
BOROUGH COUNCIL

Big plans, bright future.

Community Services and Transport
P.O. Box 226, Kingsway House, Billingham, TS23 2YL
Tel: 01642 382959
Email: communityservices@stockton.gov.uk

Project
Bishopton Pupil Referral Unit
Marsh House Avenue, Billingham

Content
Existing Site Plan

Date	July 2021	Dwg No.	A10977 / 90 - 01
Drawn	MR	Checked	DA
Scale	1:500	Scale	@ A1
Rev	P03		